



#09-03-09-002A:

**Noise from Rear Leaf Spring Under Acceleration and High Loads  
(Replace Rear Leaf Spring Shackle)**

**Subject:**

**2006-2012 Chevrolet Express, 2006-2012 GMC Savana, Commercial  
Cutaway Vans - G33503, G33803, G33903**

---

**This bulletin is being revised to add the 2011 and 2012 model years. Please  
discard Corporate Bulletin Number 09-03-09-002 (Section 03 – Suspension).**

---

[Condition](#)

Some customers may comment on a noise from the rear of the vehicle. Upon Investigation, the technician may find the left and right shackle lower bushings are worn/ torn. This creates a metal to metal contact.

[Correction](#)

1. Verify the condition.
2. Raise and support the vehicle. Refer to Lifting and Jacking the Vehicle in SI.
3. Support the rear axle independently in order to relieve the tension on the leaf springs.

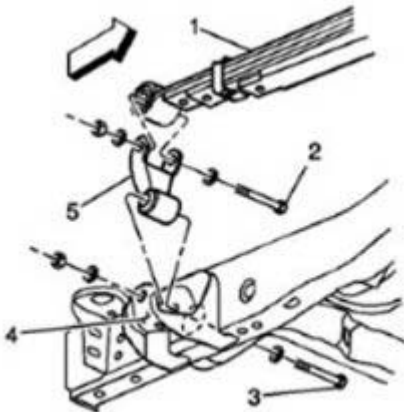

4. Remove the leaf spring (1) to the spring shackle (5) mounting bolt and nut (3). Replace the leaf spring shackle with GM P/N 20773420.

5. Install the leaf spring (1) to the spring shackle (5) mounting bolt and nut (3).

6. Tighten the spring shackle to frame mounting nut.

**Tighten**

Tighten the nut to 115 N·m (85 lb ft).

7. Tighten the spring shackle to leaf spring mounting nut.

**Tighten**

Tighten the nut to 85 N·m (63 lb ft).

8. Remove the rear axle support.

9. Repeat the same procedure for the other side.

10. Lower the vehicle.

## Parts Information

Part Number	Description	Qty
20773420	SHACKLE ASM-RR SPR	2

## Warranty Information

For vehicles repaired under warranty, use:

Labor Operation	Description	Labor Time
E9509*	Replace Rear Leaf Spring Shackle	1.0 hr

\*This is a unique labor operation for bulletin use only. It will not be published in the Labor Time Guide.

GM bulletins are intended for use by professional technicians, NOT a "do-it-yourselfer". They are written to inform these technicians of conditions that may occur on some vehicles, or to provide information that could assist in the proper service of a vehicle. Properly trained technicians have the equipment, tools, safety instructions, and know-how to do a job properly and safely. If a condition is described, DO NOT assume that the bulletin applies to your vehicle, or that your vehicle will have that condition. See your GM dealer for information on whether your vehicle may benefit from the information.

© 2011 General Motors. All rights reserved.

WE SUPPORT  
VOLUNTARY  
TECHNICIAN  
CERTIFICATION